

VT.588PAV

Our Cascade Range for Floor & Wall comes in hundreds of different designs, colours, slip ratings and finishes. Much of the range is accredited to rigorous eco-friendly standards (including LEED/BREEAM etc) to help specifiers meet the sustainability goals of their clients.

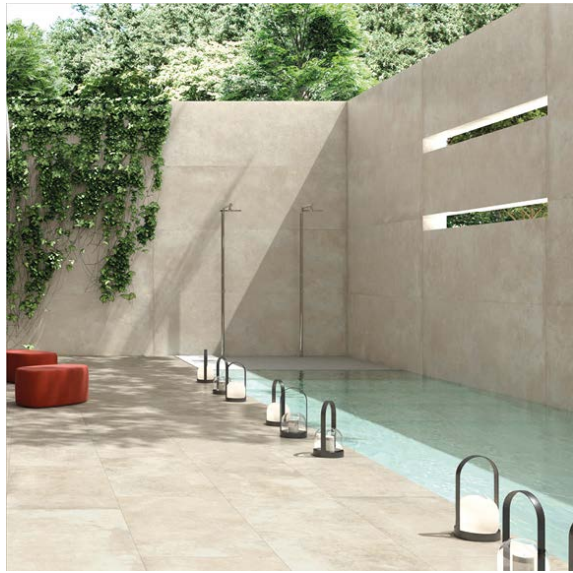

MOBILE SAMPLE LIBRARY REFERENCE
Concrete Look
High Slip Paver
Porcelain

Grip Paver

Properties

Carbon Offset

Chemical Resistant

Frost Resistant

Thermal Shock Resistant

More Colours Available

LEED

EMAS

ISO 9001

ISO 14001

R11

PTV 36+

UP TO 40% Recycled Content

Other formats available

Solid

Other finishes available

Semi Polished

Grip

Natural

Sizes available

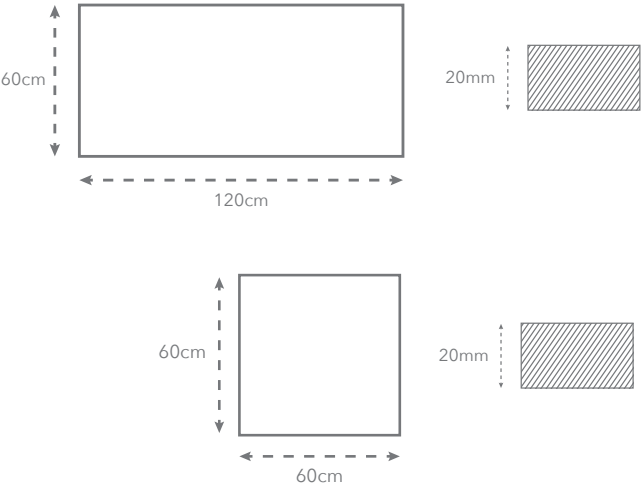

Technical Specification

Code: VT.588PAV



Eco Friendly Tiles Ltd
Ground Floor, Solon House
40a Peterborough Road
London
SW6 3BN
0844 980 2233
info@ecofriendlytiles.co.uk
www.ecofriendlytiles.co.uk

Physical & chemical properties	Norm/test method	Required Standard	Results
Thickness	EN ISO 10545-2	± 5.0% / ± 0.5mm	± 5.0%
Length and Width	EN ISO 10545-2	±0.6% Max	± 0.2%
Linearity	EN ISO 10545-2	± 0.5% Max	± 0.2%
Warpage	EN ISO 10545-2	± 0.5% Max	± 0.2%
Water absorption	EN ISO 10545-3	≤ 0.5%	≤ 0.06%
Breaking Modulus	EN ISO 10545-4	≥ 1300N	50 N/mm ² (561kg/cm ²)
Breaking Strength	EN ISO 10545-4	≥ 700N	2500 N ≥ 700N
Deep Abrasion Resistance	EN ISO 10545-6	≤ 175 mm ³	< 143 mm ³
Coefficient of Linear Thermal Expansion	EN ISO 10545-8	< 9*10 ⁻⁶ °C ⁻¹	< 6.5*10 ⁻⁶ °C ⁻¹
Frost Resistance	EN ISO 10545-12	-	Frost Proof
Resistance to Chemicals	EN ISO 10545-13	UB Minimum	Compliant
Resistance to Stains	EN ISO 10545-14	1 < X < 5	Class 5
Colour Resistance to Light	DIN 51094	-	No change
Slip Resistance	DIN 51130	-	R11
	BS 7976-2:2002 Pendulum	-	PTV 36+

Certifications



This technical information sheet is not a guarantee of performance and is not a warranty, either explicit or implicit. Rather, it tries to summarize for the designer, installer or developer the technical data provided to Eco Friendly Tiles by the independent tile manufacturer. This information may not be applicable in all geographical areas. It is the responsibility of those individuals who are referring to this document to independently research and determine which tiles are suitable for a given project according to applicable British or International Standards and any governing legislative requirements. This document cannot be used as expert opinion, evidence or in any legal or administrative procedure unless authorized by Eco Friendly Tiles Ltd.